



**A
Walk
Around
Historic Bathurst**

Bathurst's heritage is reflected in the beautiful buildings and parks lining the streets of the CBD. Park your car and take a walk around just a few blocks to see some of the delights of Australia's oldest inland settlement.

- 1. MACHATTIE PARK** - Located on the site of a former Bathurst gaol (built 1844, demolished 1889). Machattie Park was built in the 1890s. Many memorials in the park are dedicated to significant townspeople of the day including Bathurst mayors Machattie, Griffin and Webb, and doctors Busby, Basset and Brooke Moore. A plaque at the entry to the Fernery commemorates the visit to Bathurst of Charles Darwin in 1836. The Begonia House opens in autumn when the flowers are in bloom. (A Machattie Park Walk information sheet is available from the Bathurst Visitor Information Centre.)
- 2. CATHOLIC CATHEDRAL OF ST MICHAEL & ST JOHN** - The site was granted to the Catholic Church in 1838 and a church (later demolished) built in the 1840s. Ben Hall was married there in 1856. The foundation stone for the Cathedral was laid in 1857 and the first mass celebrated in 1861. It was extensively remodelled by J J Copeman late in the 19th century and then altered and extended in 1962. Further restoration is currently in progress. Ben Chifley's State Funeral was held here in 1951.
- 3. BROOKE MOORE CENTRE** - The ground floor of this building was originally erected as the parsonage for the Wesleyan Church in 1852. The upper storey was added in 1900 after it was purchased by prominent local doctor John Brooke Moore.
- 4. FORMER WESLEYAN CHURCH & HALL (*now the Uniting Church & Hall*)**
The hall was built in 1837 and for several years in the 1860s it served as a chapel and school. Still used as a hall today, it is one of the oldest buildings in Bathurst. The church building was commenced in 1857 with the spire added in 1876 and renewed in 1912.
- 5. WAR MEMORIAL CIVIC CENTRE** - The first town hall was erected here in 1875 and the present building in 1957-58. Victors Walk footpath honours the winners of races at Mt Panorama. The sculpture in the fountain is a replica of the Holtermann nugget, the largest gold specimen in the world, found at nearby Hill End.
- 6. KING'S PARADE** - The Market Building was on this site from 1859-1909. After its demolition, three significant memorials were erected. The **South African Boer War Memorial** was dedicated by Lord Kitchener in 1910. The name of Peter John Hancock, who was executed by firing squad with "Breaker" Morant, was added in 1964. In 1913, **King's Parade** was officially opened. The **Evans Memorial** (1920) depicts the surveyor George Evans and an Aboriginal man looking westward. Unique in the southern hemisphere, the **Bathurst War Memorial Carillon** was erected between 1930-1933 in remembrance of local citizens who served in WWI but is now a memorial to all locals who died in war and peacekeeping services. The 35 bells play at noon and 1pm daily and chime on the quarter hour
- 7. THE ROYAL HOTEL** - Built in the late 1830s or early 40s as a single storey inn, it had many additions before reaching the three floors you see today. By the 1870s the Royal Hotel was regarded as Bathurst's leading inn and the fashionable place to stay. Dame Nellie Melba stayed here before singing at the Bathurst School of Arts. The

rich lace detailing and cast-iron balustrade was added in the 1890s.

8. FORMER TECHNICAL COLLEGE (TAFE) BUILDING - The foundation stone for this magnificent brick and tiled facade building was laid in 1896. The nearby Ribbon Gang Lane is believed to be the site of the public hanging of the Ribbon Gang. The ten bushrangers had to build their own scaffolding before they were hanged. The modern TAFE building is located on Panorama Ave, near Mt Panorama.

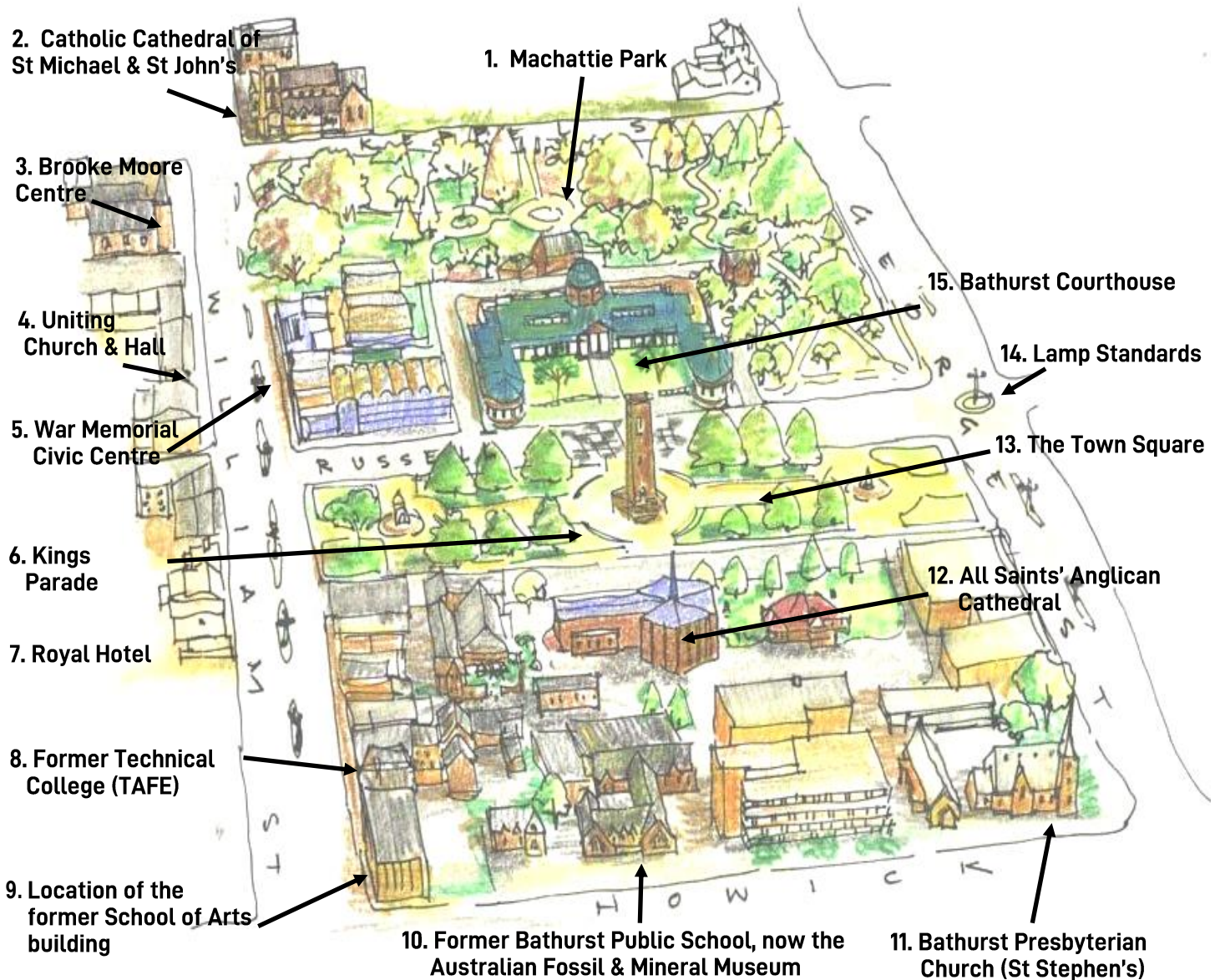

9. CORNER WILLIAM & HOWICK STS - James Rutherford, General Manager of Cobb & Co, was heavily involved in the **Bathurst School of Arts** from 1865 to 1910. On this site he laid the foundation stone (1874) for the building that also housed the **general office of Cobb & Co** from 1876-1911. Only a section of the original building remains today.

10. FORMER BATHURST PUBLIC SCHOOL, now home of the Australian Fossil & Mineral Museum - The main building was opened in 1878 as Bathurst's first purpose-built public school. For many years it was part of the Technical College but underwent extensive refurbishment and is now home to the Somerville collection, the lifetime work of Warren Somerville AM.

- 11. BATHURST PRESBYTERIAN CHURCH (FORMERLY ST STEPHEN'S)** - Built in 1872, it includes a bell in its tower dating from 1820. This is the oldest continuously used Presbyterian Church in Australia. The hall beside the church was funded by James Horne Stewart in 1908. The first Presbyterian church in Bathurst was built in William Street where the Stocklands Shopping Centre is now located and some bricks from the church have been incorporated into the façade of the shopping centre. The pre-school next to the church was named for the wife of the late prime minister Ben Chifley. She bequeathed their house and its contents to this church.
- 12. ALL SAINTS' ANGLICAN CATHEDRAL** - The first All Saints' church was built in 1845, but most of it was replaced in 1971 when the original building became unsound. Only the Warriors' Chapel remains. A plaque in memory of James Rutherford is located inside the building. The construction of the new bell tower was completed in July 2009 with the five historic Warner bells from the first church reinstalled along with 3 new Taylor bells to complete the musical octave of 8. Windows in the bell tower allow people to see the bellringers and the bells.
- 13. THE TOWN SQUARE** - Laid out by surveyor Mitchell in 1833, the Square encompassed the whole block surrounded by William, George, Russell and Howick Streets, with the Anglican Church in the centre. Over the years the original square has been taken over by buildings, with King's Parade the only remaining open public space.
- 14. STREET LAMP STANDARDS** - Important features of the Bathurst streetscape are the lamp standards in the parks and main streets. The ornate street lamps that are an interesting mix of Victorian and Art Deco were installed around 1924 when the electricity supply was connected. Many of the lamps in the parks are original structures that were once lit by gas.
- 15. BATHURST COURTHOUSE** - Designed by Government architect James Barnett, the Courthouse was built in 1880 and the old courthouse in front of the current main building was demolished. Court sessions are still conducted in the main building while the left wing, once the Post Office, now houses the Bathurst District Historical Society's museum and archives. The right wing, where the Telegraph Office was located, is now the Mitchell Conservatorium of Music.

Bathurst Visitor Information Centre would like to thank Barbara Hickson for her assistance with this publication.